

ComicByte[®]
switch to GOD MODE

QUANTUM

DUAL MODE WIRED + WIRELESS CONTROLLER



USER MANUAL



**ALL IN ONE
CONTROLLER**



**1000MAH
BATTERY**



**BACKLIST
ACTION BUTTONS**



**UPTO 10 METERS
WIRELESS RANGE**



**DUAL VIBRATION
MOTORS**



**MAGNETIC
TRIGGERS**



**MAGNETIC
JOYSTICKS**



RGB LED



PROGRAMMABLE BUTTONS



TECHNICAL SPECIFICATIONS





Input Voltage:	4.5~5.5V, 350mA
Working Voltage:	3.4~4.5VV
Battery Capacity:	1000mAh
Product Size:	mm
Product Weight:	250+10g
Product Material:	ABS
Bluetooth Version:	Bluetooth V5.3
Compatible with:	PS4/PS3/Switch/PC/Android/iOS

FEATURES

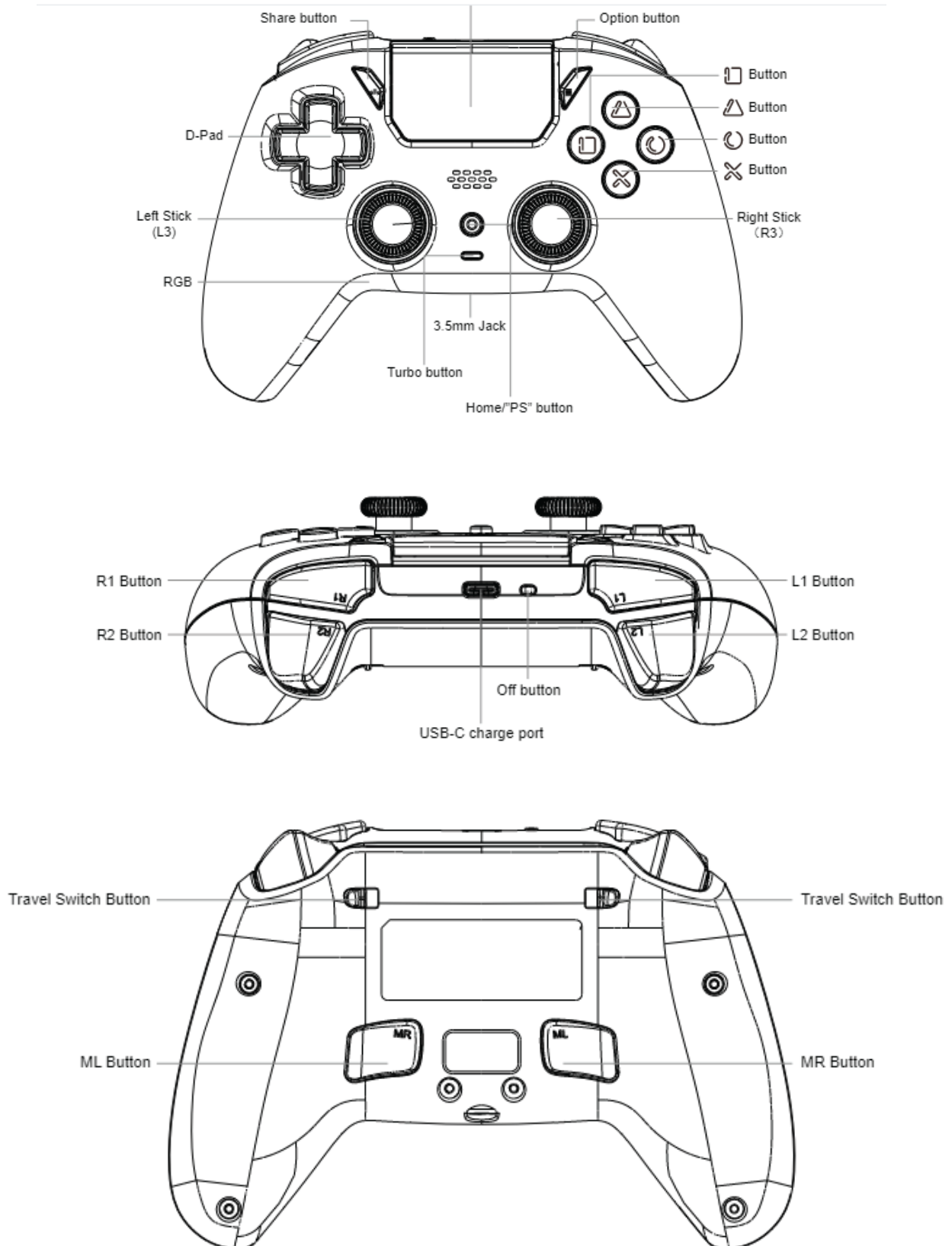
1. Dual vibration motors,
2. Six-axis sensor
3. Touch function
4. 3.5mm audio port
5. Speaker
6. Hall sensor magnetic triggers
7. Two level trigger options (digital trigger or analog hall sensor trigger)
8. Bluetooth version 5.3
9. Type-C charging port
10. RGB LED

CONTROLLER DESIGN



1. Left stick (L3)
2. Direction pad
3. Share button ("share")
4. Touchpad
5. Option button (option")
6.  Square button
7.  Triangle button
8.  Circle button
9.  Cross button
10. Right stick (R3)
11. Turbo button
12. 3.5 mm audio port
13. Home/"PS" button
14. Travel switch button
15. Travel switch button
16. ML button
17. MR button
18. R2 button
19. R1 button
20. L1 button
21. L2 button
22. Off button
23. USB-C charge port

LED ADJUSTMENT

RGB Brightness Settings

- There are six brightness levels, 0%-20%-40%-60%-80%-100%
- Hold the "Options" then press Up button on the D-Pad to increase the LED brightness.
- Hold the "Options" then press Down button on the D-Pad to decrease the LED brightness.

RGB Mode Settings

- Hold the "Options" button then press left or right button of the D-Pad to change different RGB LED effects.
- The controller will always remember the last RGB effect.

SLEEP AND WAKE-UP

If the controller is in search mode and is unable to establish communication with the PS4 console within 15 seconds, it will enter sleep mode. If the controller is in connected mode, and there is no button press or significant movement of the 3D joystick for approximately 10 minutes, the controller will enter sleep mode. Pressing the PS button during sleep will wake up the controller. The duration of inactivity before sleep can be adjusted on the console.

CONNECTION

PS4

This product connects wirelessly with Bluetooth with PS4.

First time connection to a PS4 console:

Connect the USB cable to the controller and to the PS4 console.

Press the home/"PS" button. The LED will turn solid, indicating successful connection. Disconnect the cable, the controller will now work wirelessly via Bluetooth.

Reconnect: Press and hold the home/"PS" button for about 1 second, the game controller will connect automatically to the console.

You can also play on the PS4 in wired mode, thus charging the controller at the same time.

PS5

The controller has very limited compatibility with PS5. Similar to an original PS4 controller, Only PS4 games on PS5 will support the controller, however a PS5 game on PS5 will not support the controller.

Please note that the game controller is not suitable for starting up a PS5. We recommend using an original controller for PS5 for starting up and then using this game controller as a back up or as a 2nd game controller.

PC

Wired connection: First time connection to PC. Connect the controller with the USB cable to the PC. Default is PS4 Controller mode, recognized by PC as "Wireless Controller" and blue LED. This mode supports PC STEAM platform and headphone function.

Long press Share + Option button for 3s and to change to PC X-input mode.

Bluetooth Connection:

If your PC has Bluetooth, then you can connect to it wirelessly through the Bluetooth settings.

Press Share + Home/PS button when the gamepad is off till the led starts blinking and gamepad enters pairing mode.

Search Dualshock 4 controller in bluetooth and pair.

Please Note: Controller only works as PS4 Controller and not X-input mode using bluetooth on PC. it is detected as "Wireless Controller" with blue light.

NINTENDO SWITCH

Wired connection: Connect the USB cable to the gamepad and to the switch console, Press the home/PS button, the LED will turn solid, indication successful connection Wired connection can support headphone jack function.

BLUETOOTH CONNECTION:

Method 1: First follow wired connection steps, then disconnect the cable, the controller will now work wirelessly via bluetooth connection.

Method 2: To directly connect using Bluetooth, go to " Change Grip/Order page", on switch, then connect the game controller (when gamepad is powered off) by pressing and holding Options + PS button until the 4 Led lights flash quickly, then release the button and wait for the connection to complete.

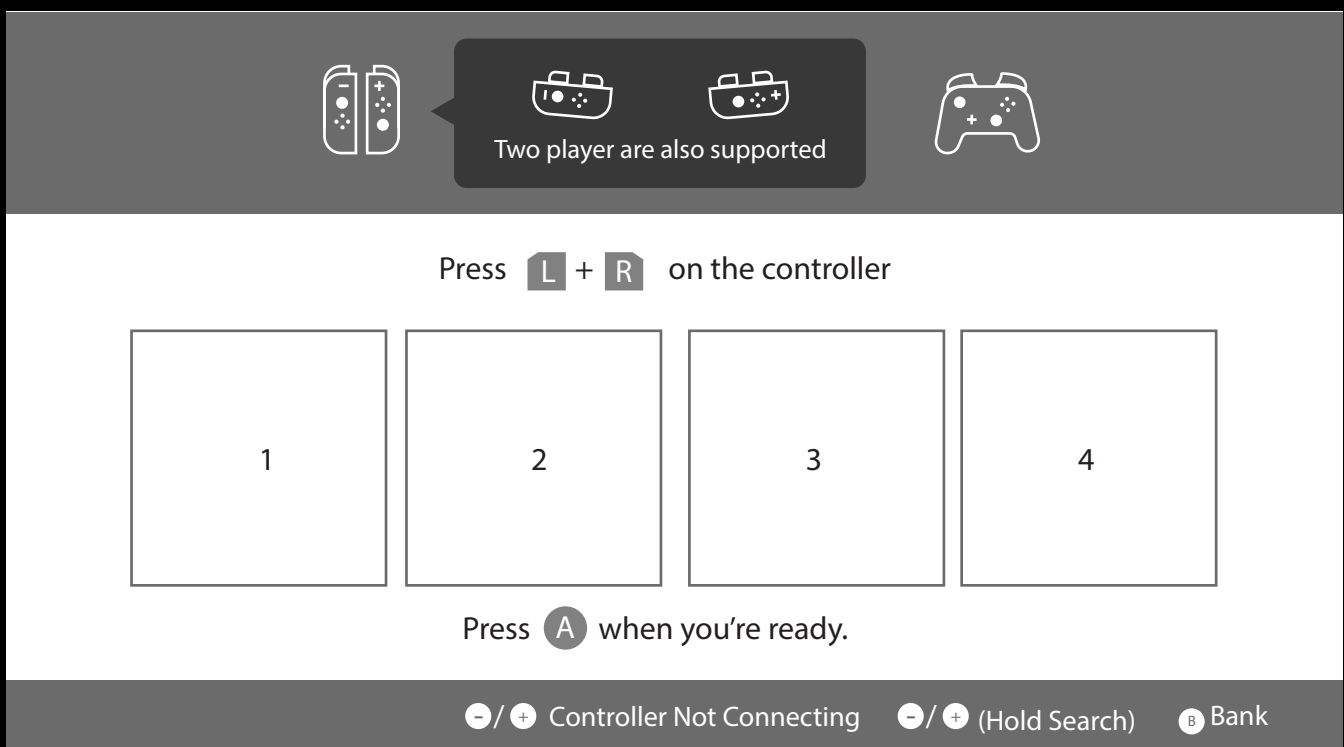

NOTE: Enter Change Grip/Order page by turning on switch and then visting "Controllers >Change Grip/Order "

Reconnect: Press and hold the home/"PS" button for about 1 second, the game controller will connect automatically

IOS DEVICE

The controller support Apple devices with iOS 13.0 and higher version, allowing compatibility with games available on the Apple Store.

Connection: Connect the game controller by pressing Share + PS buttons till the LED flashes in white color.

Connect to the game controller via the Bluetooth settings on your device, recognized by bluetooth for "DUALSHOCK 4 Wireless controller"

When connected, the LED indicator will be pink colour.

If mobile can't search controller successfully, it will be go into sleep mode after 60 seconds.

Note:

Bluetooth devices work with limited functionality. For example, buttons and some games may not work as expected as games may not support controllers.

ANDROID DEVICE

To connect the controller to an Android device, follow these steps:
Ensure the controller is powered off.

Connect the game controller by pressing Share + PS buttons till the LED flashes in white color.

Open your Android device Bluetooth settings.

Search for the Bluetooth name "Wire less controller" and tap to connect.

The light on the controller will turn white once connected.

If the controller cannot connect to the device, it will go into sleep mode after 60 seconds.

To power off the controller when it's connected to the Android device, press and hold the PS button for 10 seconds.

TURBO BUTTON

Buttons Available to Set the Turbo Function: Triangle, square, circle, cross, L1, L2, R1, R2, L3, R3

Enable/disable the manual and auto turbo speed function:

Step1: Press the TURBO button and one of the function button simultaneously, to enable the manual turbo function.

Step2: Repeat the step 1, to enable the auto turbo function.

Step3: Repeat the step 1 again, to disable the manual and auto turbo function for this button.

There are 3 levels of turbo speed:

- Minimum 5 shoots per-second, the corresponding channel light flashes slowly.
- Moderate 15 shoots per-second, the corresponding channel light flashes at a moderate rate.
- Moderate 25 shoots per-second, the corresponding channel light flashes quickly.

How to increase the turbo speed:

When the manual turbo function is on, hold the TURBO button and the right joystick up to increase one level of turbo speed.

How to decrease the turbo speed:

When the manual turbo function is on, hold the TURBO button and the right joystick down to decrease one level of turbo speed.

Turn Off All the Turbo Functions for All Buttons:

Press and hold the Share + Turbo button for 1 seconds until the controller vibrates, which will turn off the turbo functions for all buttons.

MACRO DEFINITION FUNCTION SETTING

There are two macro-buttons ML/MR on the back of the controller. ML/MR can be programmed into 1-12 function buttons respectively.

Function Buttons that can be programmed into ML/MR:

Cross/Triangle/Square/Circle/R1/R2/L1/L2/up/down/left/right buttons.

1)When the controller is on, press turbo button for 3s, LED light will flash slowly and the controller vibrates, meaning controller has entered the macro definition programming mode.

2)Press the function buttons that need to be set in sequence. At this time, the macro definition will record the time interval of each button press, and then press the ML/MR button to save, the LED channel is always on and has a vibrate to remind. (For example: Press turbo button for 3s, LED light will flash slowly and the controller vibrates, then press the B button, press the A button after 1 second, and press the X button after 3 seconds. After the setting is completed, press the ML button to save and exit. Now press the ML Button. It will work as B, A after an interval of 1 second, and X after an interval of 3 seconds). You can test whether the setting is successful on the host, "Settings > Controllers and Sensors > Check Input Devices > Check Buttons" interface.

3)Clear macro definition function: When the controller is on, press TURBO button for 3S, LED light will flash slowly and vibrate, then press the ML/MR Button, LED light will stay steady, means macro is cleared for the pressed ML or MR button.

*The macro definition function will be stored in memory. After the controller is disconnected and connected to the host, it will automatically remember the last macro definition setting.

CHARGING

Use the included USB-A to USB-C cable to charge the controller. Connect to a USB power source such as a computer with a USB-A port. We do not recommend using adapter as it can damage the battery of the controller.

When charging the controller in turned off state, it will display a breathing light in orange color. The light will turn off once fully charged.

Low Battery Warning:

In connected mode, if the controller battery voltage drops below 3.5V (based on battery characteristics), the LED will flash three times rapidly to indicate low voltage, and if the voltage drops below 3.4V, the controller will automatically turn off.

Power Off

To power off the controller while it is in the ON state, press and hold the PS button for 8-10 seconds until the controller light turns off.

Connection Distance:

The controller has a connection distance of 10 meters. If it goes beyond this distance, it will automatically power off.

Reset Controller

In case of any abnormal behavior of the controller, you can perform a factory reset by pressing the reset button on the front of the controller.

SUPPORT DETAILS

Phone: 07969273222 (Mon-Sat 10:00AM to 6:00PM)
Email: cc@thecosmicbyte.com

WARRANTY

The Controller carries 1 Year warranty against manufacturing defects only. Physical, Water damage and Tampered products are not covered under warranty. Regular wear and tear of battery from usage is not covered under warranty.



Scan the QR code to know the Warranty Claim Procedure.

FAQ'S

support.thecosmicbyte.com